

# FEIDER



## 7-IN-1 WORKBENCH

**FST7IN1-1**

## USER GUIDE

CAUTION: Read this manual before using this machine!

# CONTENTS

1. INTENDED USE.....	3
2. GENERAL SAFETY RULES.....	3
3. PRODUCT DESCRIPTION.....	4
4. TECHNICAL SPECIFICATIONS.....	4
5. ASSEMBLY.....	5
6. MAINTENANCE.....	8
7. DECLARATION OF CONFORMITY.....	8
8. WARRANTY.....	9
9. PRODUCT FAILURE.....	10
10. WARRANTY EXCLUSIONS.....	11



**WARNING!** Read carefully and understand all ASSEMBLY AND OPERATION INSTRUCTIONS before operating.

Failure to follow the safety rules and other basic safety precautions may result in serious personal injury.

This machine is designed for certain applications only. The distributor cannot be responsible for issues arising from modification. We strongly recommend this machine not be modified and/or used for any application other than that for which it was designed. If you have any questions relative to a particular application, DO NOT use the machine until you have first contacted the distributor to determine if it can or should be performed on the product.

## 1. INTENDED USE

The workbench is the ultimate 7-in-1 portable workbench, sawhorse, scaffold, platform, car creeper, dolly and hand truck. The item can be transformed easily between different modes by following the instruction manual.

This product is intended for DIY and light trade use.

## 2. SAFETY INSTRUCTIONS

### a/ GENERAL SAFETY RULES

 **WARNING:** Read and understand all instructions. Failure to follow all instructions listed below may result in serious injury.

 **CAUTION:** Do not allow persons to operate or assemble this workbench until they have read this manual and have developed a thorough understanding of how the unit works.

 **WARNING:** The warnings, cautions and instructions discussed in this instruction manual cannot cover all possible conditions or situations that could occur. It must be understood by the operator that common sense and caution are factors which cannot be built into this product, but must be applied by the operator.

SAVE THESE INSTRUCTIONS.

### b/ IMPORTANT SAFETY CONSIDERATIONS

 **WARNING:** FAILURE TO FOLLOW THESE SAFETY PRECAUTIONS AND INSTRUCTIONS COULD RESULT IN DAMAGE TO THE PRODUCT AND/OR SERIOUS INJURY TO YOU!

- Make sure all moving parts are free from interference.
- Keep hands clear of all moving parts.
- Ensure workbench is used in a dry place, protected from rain. The product is for INDOOR use only. Do not store or use it outdoors or in a moist environment.
- Keep work area well lit.
- Be aware of over balancing. When using this product in all modes, please keep your body or a heavy object in the centre or surface to avoid overbalance. Incorrect usage may cause it to turn over and result in personal injury.
- When transporting the workbench in a vehicle, always tie down to prevent movement and possible damage.
- Check to make sure that all fixing screws and knobs are tight and all legs are locked into position before operating the workbench.
- DON'T USE SCAFFOLD/PLATFORM MODE WITH LEGS FULLY EXTENDED. Always use this

product on a stable, level surface. Failure to use properly or overload may result in serious personal injury.

- When using this product with power tools, please refer to the manufacturer’s instructions for guidance on usage.
- The product must be used only for its prescribed purpose. Any use other than those mentioned in these instructions will be considered a case of misuse.
- The manufacturer shall not be liable for any damage or injury resulting from such cases of misuse.
- The manufacturer shall not be liable for any modifications made to the tool or for any damage resulting from such modifications.

### 3. PRODUCT DESCRIPTION

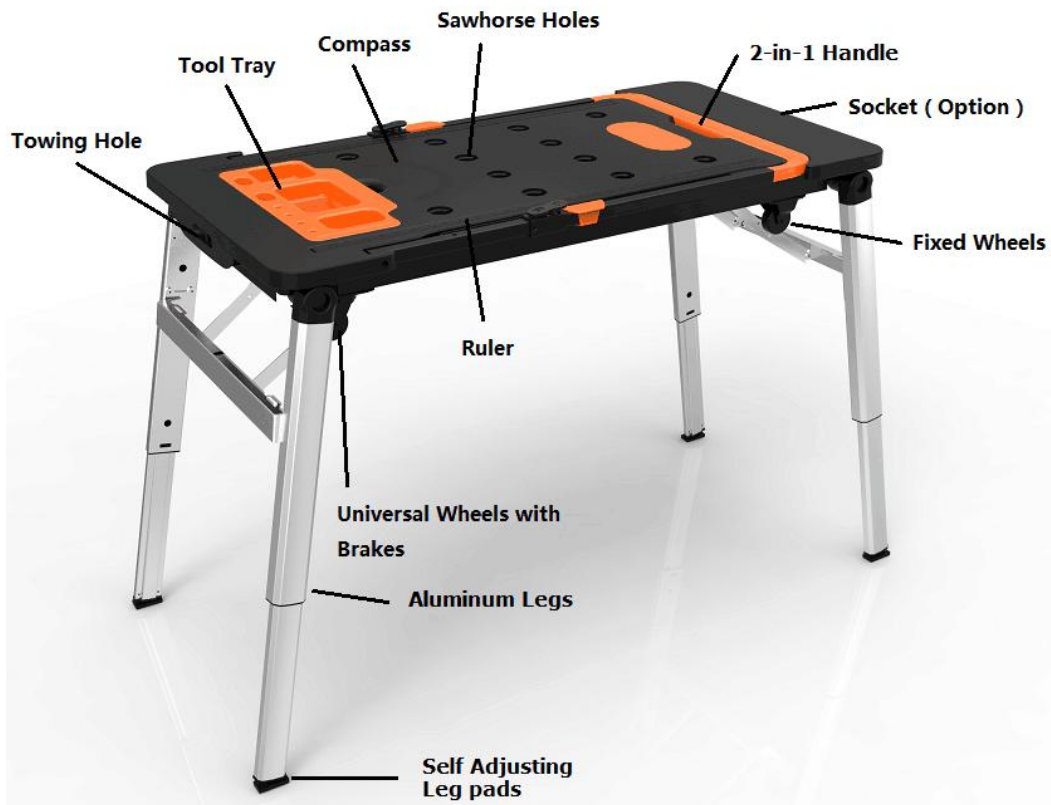

### 4. TECHNICAL SPECIFICATIONS

Work platform size	108.5 x 54.5 x 15.5 cm (42.7 x 21.5 x 6.1 Inch)
Work height	52/78 cm (20.5/30.7Inch)
Loading capacity	Workbench /Saw Horse mode: 150Kgs Scaffold / Platform mode: 250Kgs Car Creeper & Dolly mode: 150Kgs Hand Truck mode: 150Kgs
Net weight	14.5Kgs
Socket	250V 16A Max.

## 5. ASSEMBLY

Your 7-in-1 workbench comes fully assembled, just take it out of the packaging and follow the simple set up steps, then it's ready to use.

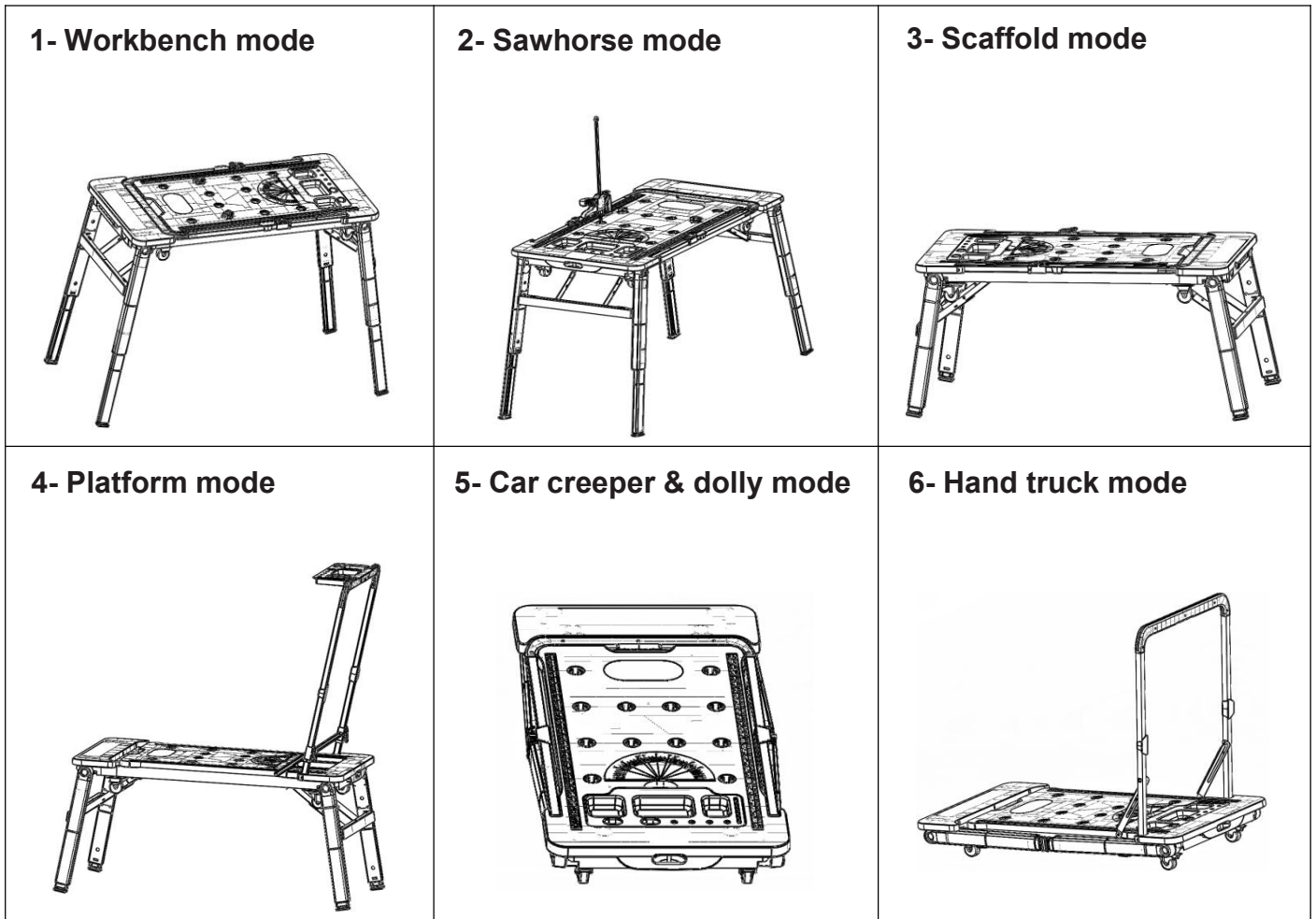

### a/ Car Creeper & Dolly Mode

Please follow these steps to install wheels in the car creeper & dolly mode:

1. Find the wheels, gaskets and screws in the back of the workbench, then line up all the screws, gasket and wheels. Notice that the 2 universal wheels with brakes should be installed under the tool tray and the left 2 fixed wheels on the other side.

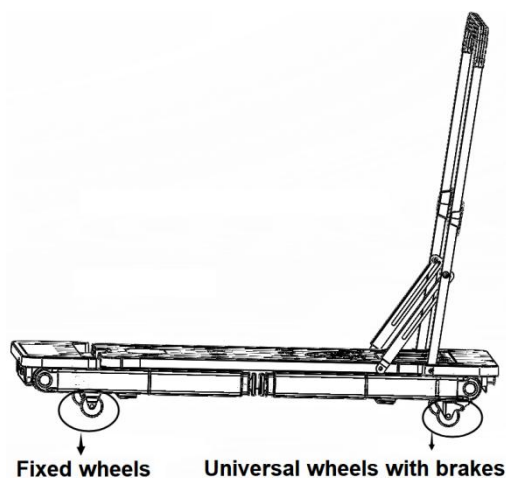

2. Put one gasket on the screw hole and secure the screw by using a screwdriver.
3. Rotate the wheel to fix the 4 screws, make sure the wheels are fully secured.
4. Follow steps 1-3 to assemble the other 3 wheels, then your car creeper is ready to go.
5. Connect a pulling rope to the towing holes, then the dolly is completed.

TIP: How to install the wheels.

The 4 wheels are packed in the back of the workbench and need to be installed by the consumer after purchase. During installation, please be aware of the following:

1. Always use the gaskets which are provided in the carton. See the illustrations above.
2. There are 2 universal/steering wheels plus 2 fixed wheels in the set, and each set of wheels has their own position. Please refer to the illustration above.

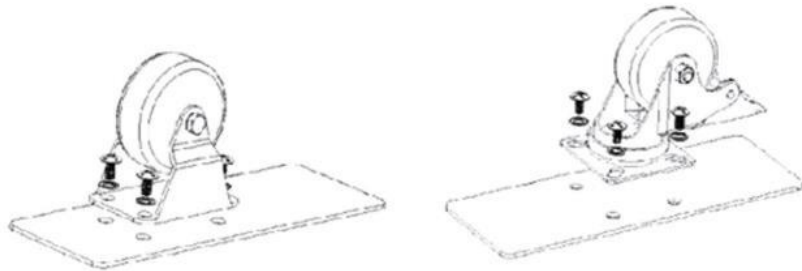

**b/ Hand truck mode**

1. Pull the handle up from the car creeper mode until you can't move it any more, push down the handle gusset braces as arrows show(pic 1), then a hand truck is ready.
2. Pull up the handle gusset braces as arrows show(pic 2), it can be withdrawn.

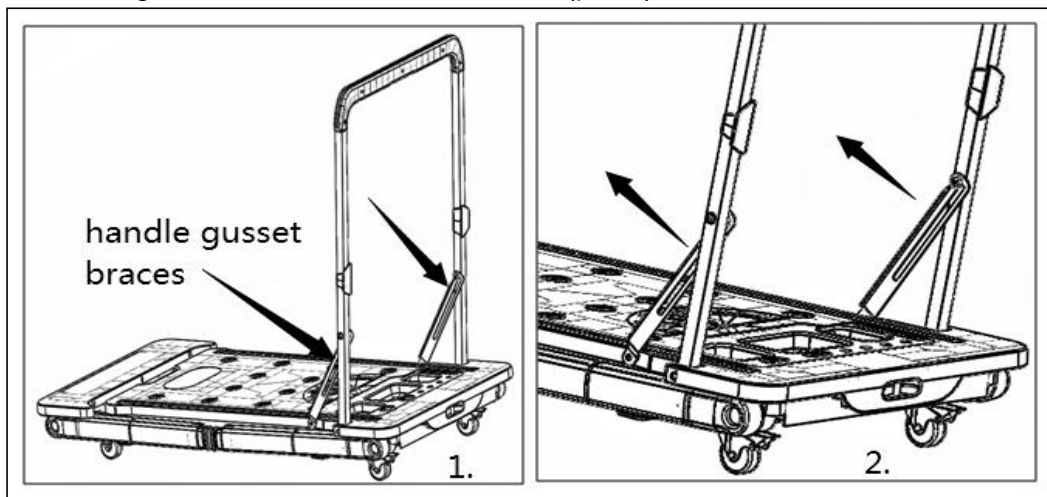

**c/ Scaffold & Platform mode**

1. Release all legs from their locking position, then rotate each pair of legs until you can't move them anymore.
2. Ensure the gusset brace is locked by pulling up it. Repeat for all the other gusset braces.
3. Pull the handle up until you can't move it any more, then release the tool tray from its locking position, put the tool tray on the top of the handle, forming a platform. THE LOADING CAPACITY FOR THE TOOL TRAY IS 2KGS (4.5LBS) IN THIS MODE.
4. Hang the hook on the handle, it can be used to hang tool bags while working on the platform.

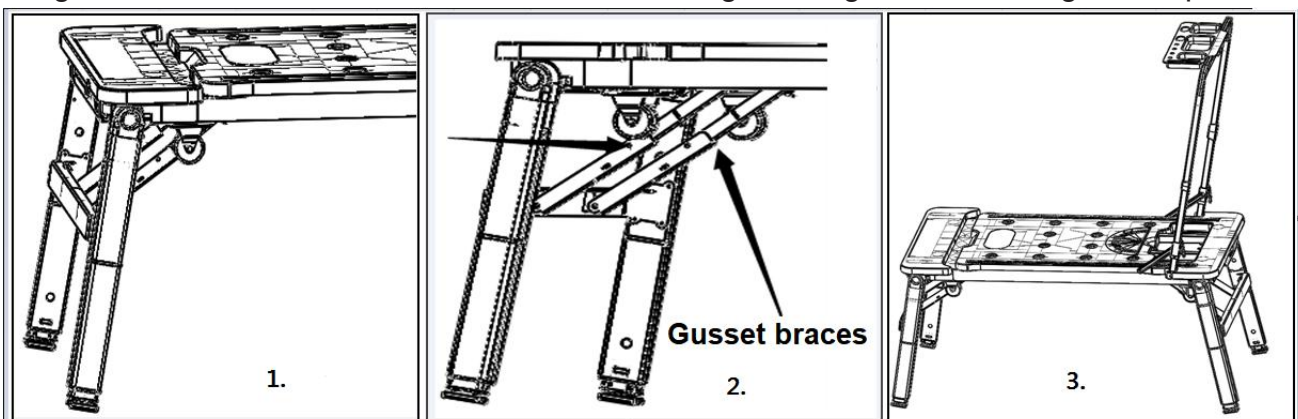

**⚠ WARNING:** DON'T USE SCAFFOLD PLATFORM MODE WITH LEGS FULLY EXTENDED. The inner legs are not designed to be used in this function.

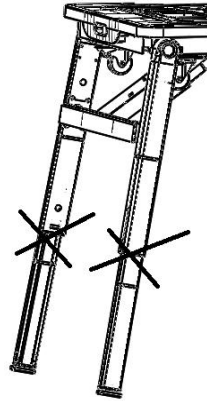

#### d/ Workbench & Sawhorse mode

- 1) Firstly, set up the legs by following the same steps as detailed within scaffold mode section. See A.
- 2) Push the snap buttons on the side of each leg to release them, then pull the inner legs out to the workbench height. When legs are fully extended they will snap into place. Gently turn the workbench upright onto a stable, level surface.

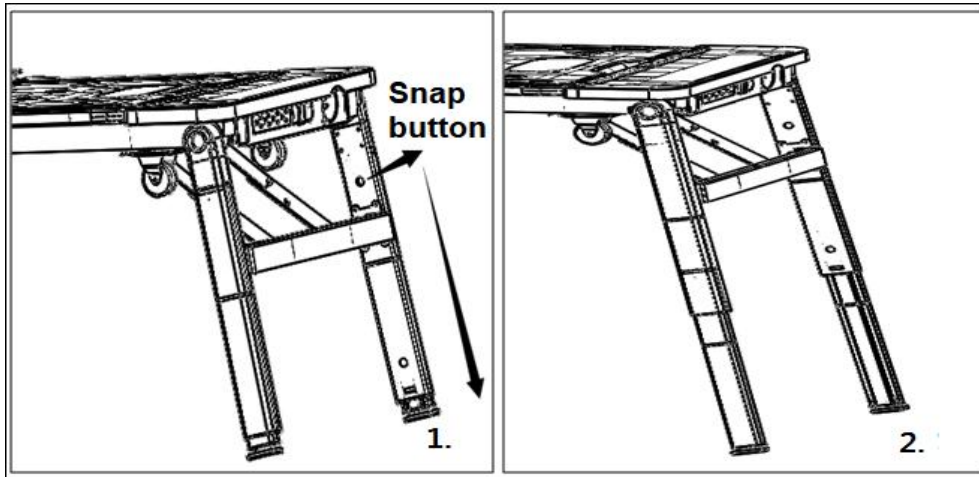

Please follow below steps to connect with a quick clamp.

- 1) Remove the small plastic part of your quick clamp
- 2) Put the steel bar into our connector (Fig 2) and put a pin into the lock hole, make sure they are connected firmly(Fig 3);
- 3) Put the connector into Sawhorse hole on the workbench surface and rotate at least 30 degrees (Fig4);
- 4) With the help of the 2 vice pegs on the workbench, a sawhorse is completed.

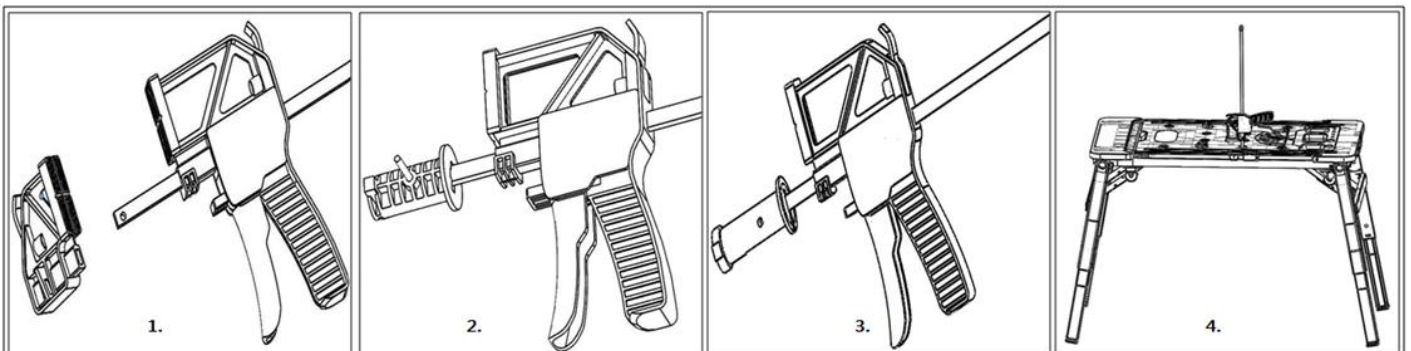

**NOTE:** DO NOT step on the workbench while the legs are fully extended.

**NOTE:** The quick clamp is not provided with this tool.

## 6. MAINTENANCE

- Maintain your workbench. It is recommended that the general condition of any workbench be examined before it is used. Keep your workbench in good repair by adopting a program of conscientious repair and maintenance. Have necessary repairs made by qualified service personnel.
- Wipe away dirt and dust from the workbench on a regular basis.

A. Depending on the model of sergeant it may be necessary to remove the ring that is placed on the sergeant's splint, to remove it use a punch or any element that makes pressure on the ring.

## 7. DECLARATION OF CONFORMITY



BUILDER SAS

32 rue Aristide Bergès - Z.I. du Casque - 31270 Cugnaux - France

Declares that the machinery designated below:

7 IN 1WORKBENCH

FST7IN1-1

Numéro de serie: 20240606402-20240606801

Is in conformity with the following Directives

Machine Directive 2006/42/CE

REACH Directive 1907/2006

This machine is also in conformity with the following standard

EN ISO 12100: 2010

Responsible of technical file: Mr Olivier Patriarca

Cugnaux, 10/05/2024

A handwritten signature in black ink, appearing to read 'Philippe MARIE'.

Philippe MARIE / CEO



## 8. WARRANTY

The manufacturer guarantees the product against defects in material and workmanship for a period of 2 years from the date of the original purchase. It can be extended by one year if the user subscribes to website of myswap. The warranty only applies if the product is for household use. The warranty does not cover breakdowns due to normal wear and tear.

The manufacturer agrees to replace parts identified as defective by the designated distributor. The manufacturer does not accept responsibility for the replacement of the machine, in whole or in part, and/or ensuing damage.

### **The warranty does not cover breakdowns due to:**

- insufficient maintenance.
- abnormal assembly, adjustment or operations of the product.
- parts subject to normal wear and tear.

### **The warranty does not extend to:**

- shipping and packaging costs.
- using the tool for a purpose other than that for which it was designed.
- the use and maintenance of the machine done in a manner not described in the user manual.

Due to our policy of continuous product improvement, we reserve the right to alter or change specifications without notice. Consequently, the product may be different from the information contained therein, but a modification will be undertaken without notice if it is recognized as an improvement of the preceding characteristic.

### **READ THE MANUAL CAREFULLY BEFORE USING THE MACHINE.**

When ordering spare parts, please indicate the part number or code, you can find this in the spare parts list in this manual. Keep the purchase receipt; without it, the warranty is invalid. To help you with your product, we invite you to contact us by phone or via our website:

**+33 (0)9.70.75.30.30**

**<https://services.swap-europe.com/contact>**

You must create a "ticket" via the web platform.

- Register or create your account.
- Indicate the reference of the tool.
- Choose the subject of your request.
- Describe your problem.

Attach these files: invoice or sales receipt, photo of the identification plate (serial number), photo of the part you need (for example: pins on the transformer plug which are broken).



**myswap**

## 9. PRODUCT FAILURE

### WHAT TO DO IF MY MACHINE BREAKS DOWN?

#### If you bought your product in a store:

- Make sure that your machine is complete with all accessories supplied, and clean! If this is not the case, the repairer will refuse the machine.
- Go to the store with the complete machine and with the receipt or invoice.

#### If you bought your product on a website:

- Make sure that your machine is complete with all accessories supplied, and clean! If this is not the case, the repairer will refuse the machine.
- Create a SWAP-Europe service ticket on the site: <https://services.swap-europe.com> When making the request on SWAP-Europe, you must attach the invoice and the photo of the nameplate (serial number).

Contact the repair station to make sure it is available before dropping off the machine.

Go to the repair station with the complete machine packed, accompanied by the purchase invoice and the station support sheet downloadable after the service request is completed on the SWAP-Europe site

**Please keep your original packaging to allow for after-sales service returns or pack your machine with a similar cardboard box of the same dimensions.**

**For any question concerning our after-sales service you can make a request on our website <https://services.swap-europe.com>**

**Our hotline remains available at +33 (9) 70 75 30 30.**



## 10. WARRANTY EXCLUSIONS

### THE WARRANTY DOES NOT COVER:

- Start-up and setting up of the product.
- Damage resulting from normal wear and tear of the product.
- Damage resulting from improper use of the product.
- Damage resulting from assembly or start-up not in accordance with the user manual.
- Periodic and standard maintenance events.
- Actions of modification and dismantling that directly void the warranty.
- Products whose original authentication marking (brand, serial number) has been degraded, altered or withdrawn.
- Replacement of consumables.
- The use of non-original parts.
- Breakage of parts following impacts or projections.
- Accessories breakdowns.
- Defects and their consequences linked to any external cause.
- Loss of components and loss due to insufficient screwing.
- Cutting components and any damage related to the loosening of parts.
- Overload or overheating.
- Poor power supply quality: faulty voltage, voltage error, etc.
- Damages resulting from the deprivation of enjoyment of the product during the time necessary for repairs and more generally the costs related to the immobilization of the product.
- The costs of a second opinion established by a third party following an estimate by a SWAP-Europe repair station
- The use of a product which would show a defect or a breakage which was not the subject of an immediate report and/or repair with the services of SWAP-Europe.
- Deterioration linked to transport and storage\*.

\* In accordance with transport legislation, damage related to transport must be declared to carriers within 48 hours maximum after observation by registered letter with acknowledgement of receipt. This document is a supplement to your notice, a non-exhaustive list.

**Attention:** all orders must be checked in the presence of the delivery person. In case of refusal by the delivery person, it you must simply refuse the delivery and notify your refusal.

**Reminder:** the reserves do not exclude the notification by registered letter with acknowledgement within 72 hours.

**Information:**

Thermal devices must be wintered each season (service available on the SWAP-Europe site). Batteries must be charged before being stored.

# FEIDER



BUILDER SAS

32 rue Aristide Bergès - Z.I. du Casque - 31270 Cugnaux - France

MADE IN PRC